

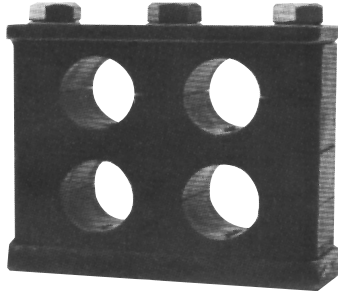

CUSHION CLAMPS

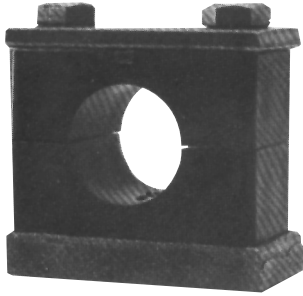

VESCOR® CUSHION CLAMP SYSTEMS are a product of the U.S.A.!

- Polypropylene cushions and quality steel hardware.
- Cushions are precisely molded to conform without distortion during installation and the solid cushion design resists crushing while absorbing shock and suppressing vibration and noise.
- Cushions are temperature rated up to 110°F and remain stable in applications subjected to light acids, solvents, fuels, minerals oils, alcohol, paints and salt water.

Vescor Heavy Duty Cushion Clamp systems are available from 1/2" thru 2 1/2" O.D. In Single, Stack and Twin Custom Systems to 4 1/2" O.D.

Single and Single Stack Cushion

Series A

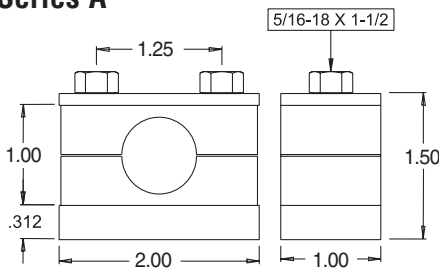

Pipe Size O.D.	Part No.	Tube / Hose O.D.	Part No.
1/8" (.405)	12P	.250	25T
1/4" (.540)	25P	.375	37T
3/8" (.675)	37P	.500	50H
		.562	56H
		.625	62H
		.687	68H
		.750	75H

.125 thru .750

Series AA

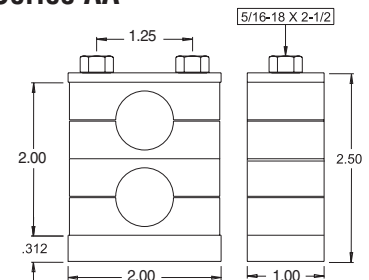

Single and Single Stack Cushion

Series B

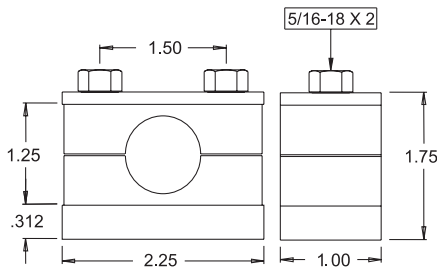

Pipe Size O.D.	Part No.	Tube/Hose O.D.	Part No.
1/2" (.840)	50P	.812	81H
3/4" (1.050)	75P	.875	87H
		.937	93H
		1.00	100H

.500 thru 1.00

Series BB

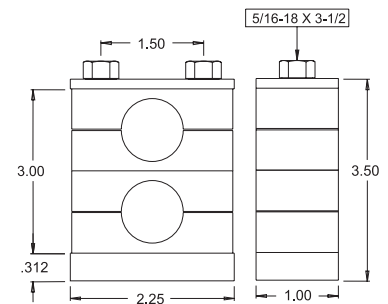

HOW TO ORDER

Example: single cushion A - 25T - H
 single stack BB - 100H - 100H - H

Series — Part Number — H = All hardware
 C = Cushion set only



CUSHION CLAMPS

Single and Single Stack Cushion

Series C

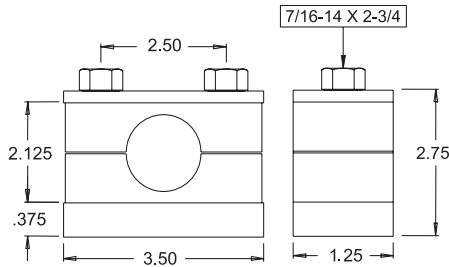

Pipe Size O.D.	Part No.	Tube/Hose O.D.	Part No.
1" (1.315)	100P	1.063	106H
		1.125	112H
		1.187	118H
		1.250	125H
		1.312	131H
		1.375	137H
		1.437	143H
		1.500	150H

1.00 thru 1.50

Series CC

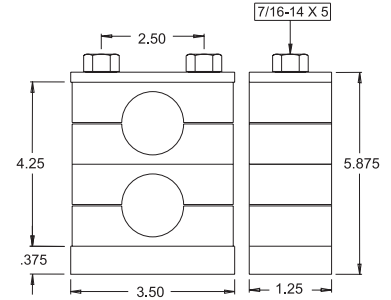

Single and Single Stack Cushion

Series D

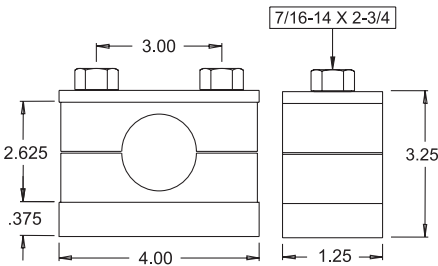

Pipe Size O.D.	Part No.	Tube/Hose O.D.	Part No.
1¼" (1.660)	125P	1.563	156H
1½" (1.900)	150P	1.563	156H
		1.625	162H
		1.687	168H
		1.750	175H
		1.812	181H
		1.875	187H
		1.937	193H
		2.000	200H

1.25 thru 2.00

Series DD

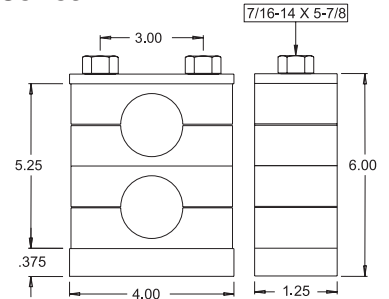

Single and Single Stack Cushion

Series E

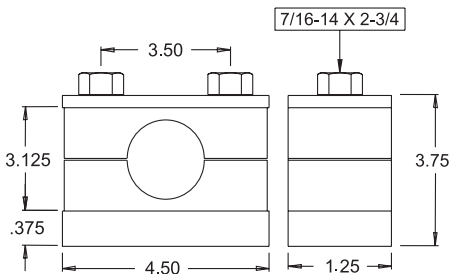

Pipe Size O.D.	Part No.	Tube/Hose O.D.	Part No.
2" (2.375)	200P	2.063	206H
2½" (2.875)	250P	2.125	121H
		2.187	218H
		2.250	225H
		2.312	231H
		2.375	237H
		2.437	243H
		2.500	250H

2.00 thru 2.50

Series EE

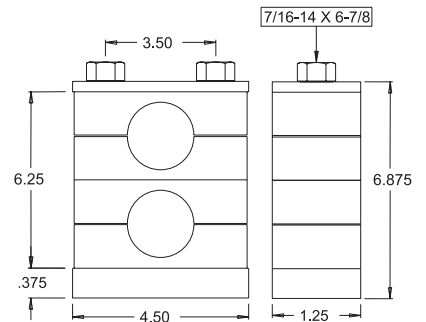

HOW TO ORDER

Example: single cushion D - 125P - H
 single stack EE - 225H - 250H - H

Series Part Number H = All hardware
 C = Cushion set only



CUSHION CLAMPS

Twin and Twin Stack Cushion

.125 thru .750

Series F

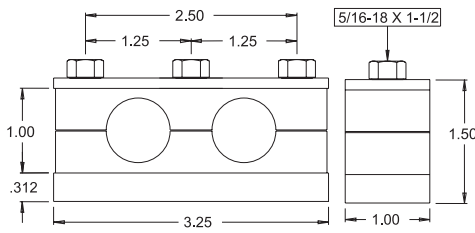

Pipe Size O.D.	Part No.	Tube / Hose O.D.	Part No.
1/8x1/8 (.405)	1212P	.250-.250	2525T
1/4x1/4 (.540)	2525P	.375-.375	3737T
3/8x3/8 (.675)	3737P	.500-.500	5050H
		.563-.563	5656H
		.625-.625	6262H
		.687-.687	6868H
		.750-.750	7575H

Series FF

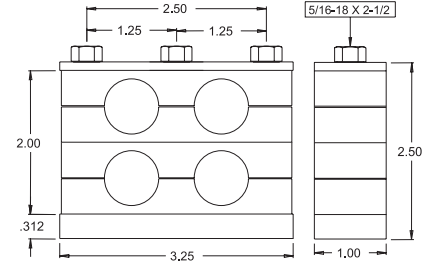

Twin and Twin Stack Cushion

.500 thru 1.00

Series G

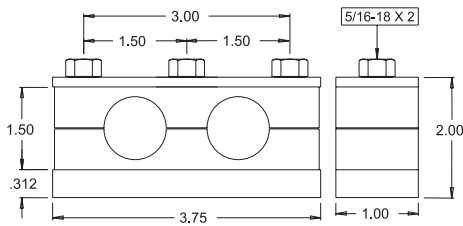

Pipe Size O.D.	Part No.	Tube / Hose O.D.	Part No.
1/2x1/2 (.840)	5050P	.812-.812	8181H
3/4x3/4 (1.050)	7575P	.875-.875	8787H
		.937-.937	9393H
		1.00-1.00	1010H

Series GG

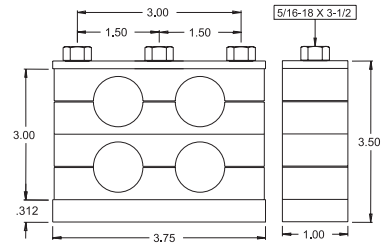

Twin and Twin Stack Cushion

1.00 thru 1.50

Series L

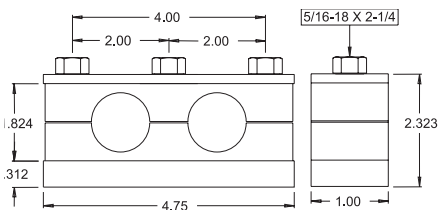

Pipe Size O.D.	Part No.	Tube / Hose O.D.	Part No.
1x1 (1.315)	1010P	1.063-1.063	106106H
		1.125-1.125	125125H
		1.187-1.187	118118H
		1.250-1.250	125125H
		1.312-1.312	131131H
		1.375-1.375	137137H
		1.437-1.437	143143H
		1.500-1.500	150150H

Series LL

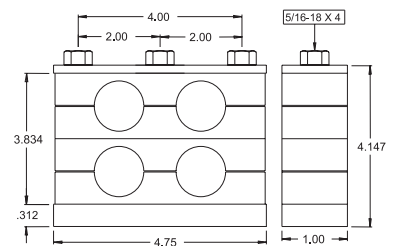

HOW TO ORDER

Example: twin cushion G - 7575P - 7575P - H Series Part Number H = All hardware
 twin stack FF - 5050H - 2525T - H C = Cushion set only



CUSHION CLAMPS

Mini Twin and Mini Twin Stack Cushion

.125 thru 5.00

Series M

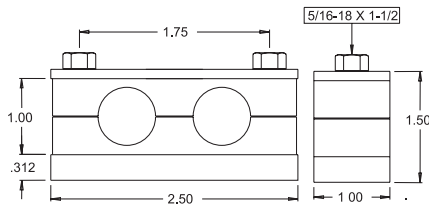

Tube O.D.	Part No.	Pipe Size O.D.	Part No.
.250-.250	2525T	1/8x1/8 (.405)	1212P
.375-.375	3737T	1/4x1/4 (.540)	2525P
.500-.500	5050T		

Series MM

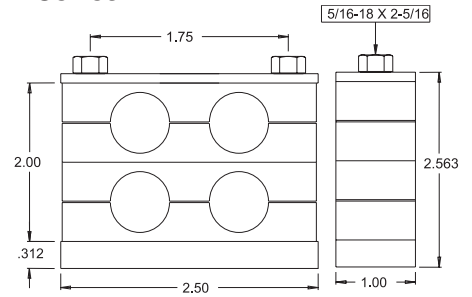

HOW TO ORDER

Example: mini twin cushion M - 5050T - H
 mini twin stack MM - 25250T - 3737T - H

Series — Part Number —
 H = All hardware
 C = Cushion set only

Single Cushion

2.50 thru 3.00

Series K

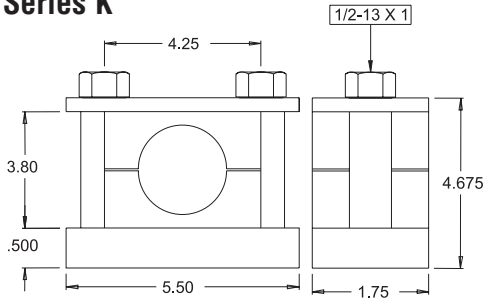

Tube O.D.	Part No.	Pipe Size O.D.	Part No.
2.50	250T	2 1/2 (2.875)	250P
3.00	300T		

HOW TO ORDER Example: K - 250P - H

K —
 Series K Part Number — H = All hardware
 C = Cushion set only

Single Cushion

3.00 thru 3.50

Series K

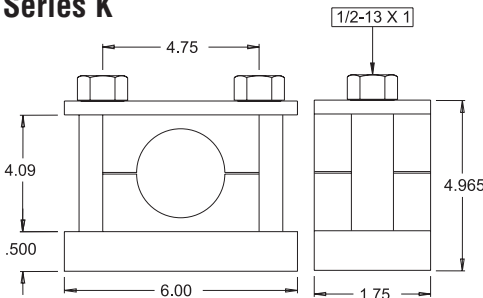

Tube O.D.	Part No.	Pipe Size O.D.	Part No.
3.50	300P	3" (3.50)	300P

HOW TO ORDER Example: K - 300P - H

K —
 Series K Part Number — H = All hardware
 C = Cushion set only

Single Cushion

4.00 thru 4.50

Series K

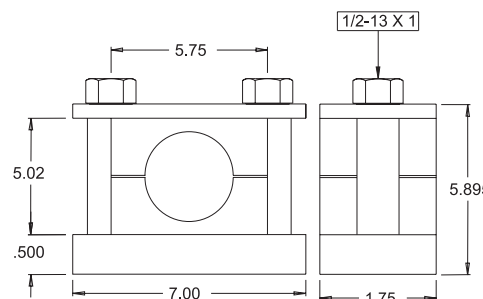

Tube O.D.	Part No.	Pipe Size O.D.	Part No.
4.00	400T	4" (4.50)	400P
4.50	400P		

HOW TO ORDER Example: K - 400P - H

K —
 Series K Part Number — H = All hardware
 C = Cushion set only

NOTE: WITH VESCORS' POLICY OF CONSTANTLY IMPROVING ITS PRODUCTS, SPECIFICATIONS ARE SUBJECT TO CHANGE WITHOUT NOTICE.